

Part # Size

SC06 2.56" gate opening

USER WEIGHT CAPACITY

ANSI 130-310 lbs. (140.6kg)

# LSD Safety Rebar Scaffold Hook

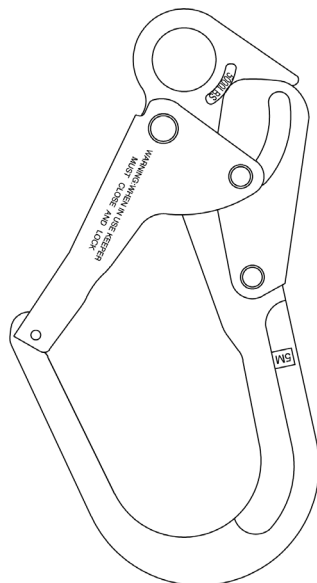
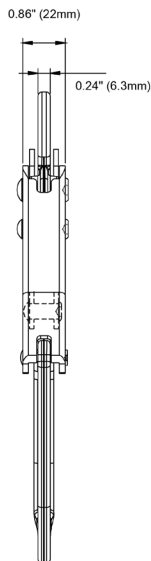
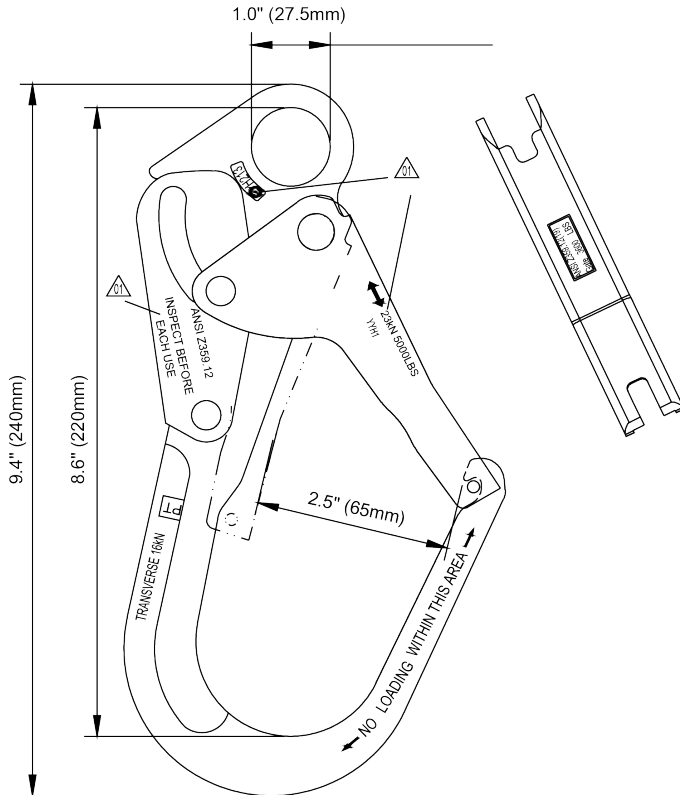

## Features:

- » Surface treatment: Zinc Plated
- » Corrosion Resistance: 48 hr. salt spray test
- » Rebar scaffold hook
- » Alloy Steel

## Design:

- » Yellow chromate finish

## Metal Materials:

- » **Material:** Forged Steel
- » **Min. Breaking Strength:** 5,000 lbs.
- » **Gate Strength:** 3,600 lbs..
- » **Open width:** 2.56 in. (65mm)

## Standards:

- » **Meets or Exceeds:** ANSI Z359.12-2019